

Form-Flex®
8 BOLT DOUBLE FLEX COUPLING
TYPE HSH, FSH, HFTH ALL SIZES

P-5028-TBW
Form 1180A

Service & Installation Instructions



(HFTH)
Figure 1

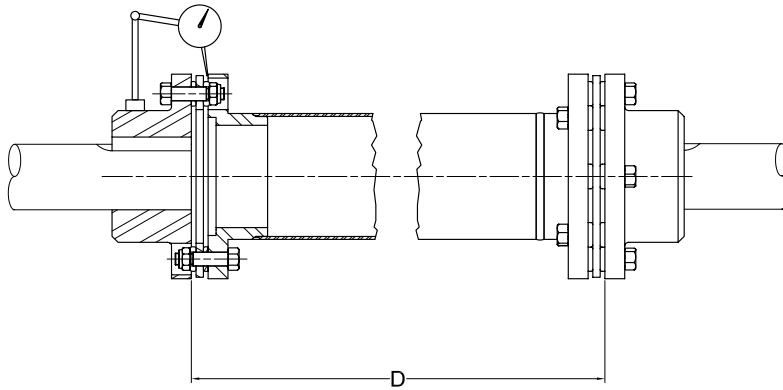

PARTS LIST

- 1. Bolt (16)
- 2. Hub (2)
- 3. Double Radius Washer (16)
- 4. Nut (16)
- 5. Spacer (1)
- 6. Flex Element (2)
- 7. Single Radius Washer (8)

(HSH)
Figure 2

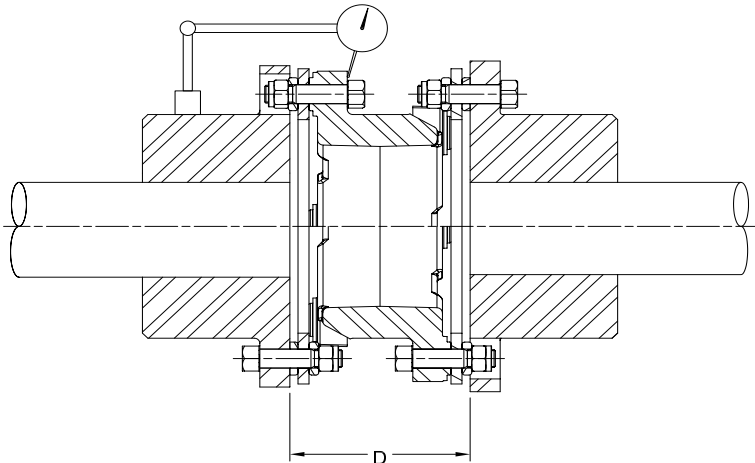

PARTS LIST

- 1. Bolt (16)
- 2. Hub (2)
- 3. Washer (16)
- 4. Nut (16)
- 5. Spacer (1)
- 6. Flex Element (2)

(FSH)
Figure 3

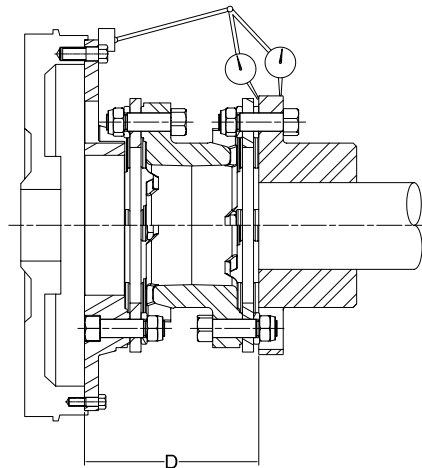

PARTS LIST

- 1. Bolt (16)
- 2. Hub (1)
- 3. Washer (16)
- 4. Nut (16)
- 5. Spacer (1)
- 6. Flex Element (2)
- 7. Adapter Plate (1)

Proper care in installing and aligning will permit couplings to operate to full capacity, compensate for mis-alignment, and provide very good service life.

- 1. Inspect shafts and hub(s) bores and make sure they are free from burrs. Check for the proper fit of the keys to the shafts and hubs.
- 2. Fit the couplings hub(s) so that the shaft end(s) is/are flush with the machined face of the flange. If the hub is bored for an interference fit, the hubs should be heated then quickly positioned on the shaft. *Do Not* spot heat or heat above 300°F as it may cause distortion.
- 3. Move the equipment to be connected into position. Set the gap to the required distance between shaft ends, D dimension. See Fig. 1, 2 or 3.

ASSEMBLY & ALIGNMENT

4. Type FSH

- a. Install bolts (1) in Flywheel Adaptor (7).
- b. Install Flywheel Adaptor (7).
- c. Attach a dial indicator to the Flywheel Adaptor (7), indicate a point on the hub (2) flange outside diameter.
- d. Rotate the Flywheel Adaptor (7) with the hub (2) stationary. The driver and driven equipment will have allowable parallel misalignment when the Total Maximum Indicator Reading (TIR) is within limits as shown in table II.
- e. Reposition the dial indicator to indicate a point on hub (2) flange face near the outside diameter.
- f. With the dial indicator attached to the Flywheel Adaptor (7) and held stationary rotate the hub (2). The driver and drive equipment will have allowable angular misalignment when the maximum indicator reading is within limits as shown in table II.
- g. With equipment aligned and using Fig. 3 as a guide attach the flex elements (6) to the Flywheel Adaptor bolts (1), position the element washers (3) over the bolts (1) and install the nuts (4).
- h. Bring the spacer (5) into position install the bolts (1) thru the spacer and flex elements, place the element washers (3) over the bolts and install the nuts (4). (The spacer must be supported at this time as not to damage the connected flex elements.)
- i. Position the flex elements between the hub (2) and spacer (5). Install the bolts (1) thru the spacer and flex elements place the element washers (3) over the bolts and install the nuts (4).
- j. Install the bolts (1) thru the hub (2) and flex elements (6) place the element washers (3) over the bolts and install the nuts (4).

- k. With equipment aligned and coupling assembled inspect all components for correct orientation. Tighten all nuts (4) to their proper torque value as shown in table I.

5. Type HSH & HFTH

- a. Bring the equipment into approximate good alignment by attaching one end of spacer (5) to a hub (2). Use Fig. 1 or 2 as a guide. (The spacer must be supported at this time as not to damage the connected flex elements.)
Note: Type HFTH has two style element washers (3) & (7) on bolt (1) position on either side of flex element (6) attached to the spacer (5). Element washer (7) must be positioned with the flat side adjacent to the spacer (5).
- b. With one end of the coupling assembled align the equipment well enough to assemble the opposite end of the spacer to the hub.
- c. Assemble the spacer to the hub using fig. 1 or 2 as a guide.
- d. Tighten all nuts (4) to their proper torque value as shown in table I with lightly oiled threads.
- e. Attach a dial indicator to each hub. Indicate a point on the nearest spacer flange. See fig. 1 or 2.
- f. Rotate the assembled coupling, the equipment will be aligned when the Total Indicator Reading (T.I.R.) is within the allowable limits as shown in table II for both ends.

6. Inspection

IMPORTANT: To ensure unlimited life recheck alignment and retorque nuts after one or two hours of actual operation. If the equipment is portable this should be done each time the equipment is moved.

TABLE I (Lightly oiled threads)

SIZE	22	26	31	35	37	42	45	50	55	60	70	75	80	85	92	92HT
FT-LB ± 10%	25	30	40	70	95	125	150	210	320	450	575	830	1000	1400	1400	2400

TABLE II Total indicator reading-inches.

SIZE	22	26	31	35	37	42	45	50	55	60	70	75	80	85	92	92HT
TIR	.003	.003	.004	.004	.005	.005	.006	.006	.007	.008	.009	.010	.011	.012	.013	.013

REPLACEMENT PARTS

To order replacement parts it is necessary to furnish the complete part number(s) and the required part(s). Order must be placed with your distributor.



WARNING: Rotating equipment is potentially dangerous and must be properly guarded. The user should comply with applicable safety codes in accordance to OSHA standards.

All Customer Service phone numbers shown in bold

Belted Drives and Sheaves

TB Wood's

Belted Drives

Chambersburg, PA - USA
1-888-829-6637 – Press #5

For application assistance:
 1-888-829-6637 – Press #7

Couplings

Ameridrives

Mill Spindles, Ameriflex, Ameridisc

Erie, PA - USA
1-814-480-5000

Gear Couplings

San Marcos, TX - USA
1-800-458-0887

Universal Joints, Drive Shafts, Mill Gear Couplings

Erie, PA - USA
1-920-593-2444

Bibby Turboflex

Disc, Gear, Grid Couplings, Overload Clutches

Dewsbury, England
+44 (0) 1924 460801

Boksburg, South Africa
+27(0) 11 918 4270

Guardian Couplings

Engineered Flywheel Couplings, Engine Housings and Pump Mounts, Flexible Shaft Couplings

Michigan City, IN - USA
1-219-874-5248

Huco

Precision Couplings and Air Motors

Hertford, England
+44 (0) 1992 501900

Chambersburg, PA - USA
1-888-829-6637

Lamiflex Couplings

Flexible Couplings, Bearing Isolators, and Coupling Guards

Cotia, SP - Brasil
+55 (11) 4615-6300

Couplings Cont.

TB Wood's

Elastomeric Couplings

Chambersburg, PA - USA
1-888-829-6637 – Press #5

For application assistance:
 1-888-829-6637 – Press #7

General Purpose Disc Couplings

San Marcos, TX - USA
1-888-449-9439

Electromagnetic Clutches and Brakes

Inertia Dynamics

Spring Set Brakes; Power On and Wrap Spring Clutch/Brakes

New Hartford, CT - USA
1-800-800-6445

Matrix

Electromagnetic Clutches and Brakes, Pressure Operated Clutches and Brakes

Brechin, Scotland
+44 (0) 1356 602000

New Hartford, CT - USA
1-800-825-6544

Warner Electric

Electromagnetic Clutches and Brakes

New Hartford, CT - USA
1-800-825-6544

For application assistance:
 1-800-825-9050

Saint Barthélemy d'Anjou, France
+33 (0)2 41 21 24 24

Precision Electric Coils and Electromagnetic Clutches and Brakes

Columbia City, IN - USA
1-260-244-6183

Engineered Bearing Assemblies

Kilian

Engineered Bearing Assemblies

Syracuse, NY - USA
1-315-432-0700

Gearing

Bauer Gear Motor

Gearred Motors

Esslingen, Germany
+49 (711) 3518-0

Middlesex, NJ - USA
1-732-469-8770

Boston Gear

Enclosed and Open Gearing, Electrical and Mechanical P.T. Components

Charlotte, NC - USA
1-800-825-6544

For application assistance:
 1-800-816-5608

Nuttall Gear and Delroyd Worm Gear

Worm Gear and Helical Speed Reducers

Niagara Falls, NY - USA
1-716-298-4100

Heavy Duty Clutches and Brakes

Industrial Clutch

Pneumatic and Oil Immersed Clutches and Brakes

Waukesha, WI - USA
1-262-547-3357

Svendborg Brakes

Industrial Brakes and Brake Systems

Vejstrup, Denmark
+45 63 255 255

Twiflex

Caliper Brakes and Thrusters

Wichita Falls, TX - USA
1-844-723-3483

Twickenham, England
+44 (0) 20 8894 1161

Wichita Clutch

Pneumatic Clutches and Brakes

Wichita Falls, TX - USA
1-800-964-3262

Bedford, England
+44 (0) 1234 350311

Linear Products

Warner Linear

Linear Actuators

New Hartford, CT - USA
1-800-825-6544

For application assistance:
 1-800-825-9050

Saint Barthélemy d'Anjou, France
+33 (0)2 41 21 24 24

Overrunning Clutches

Formsprag Clutch

Overrunning Clutches and Holdbacks

Warren, MI - USA
1-800-348-0881 – Press #1

For application assistance:
 1-800-348-0881 – Press #2

Marland Clutch

Roller Ramp and Sprag Type Overrunning Clutches and Backstops

Warren, MI - USA
1-800-216-3515

Stieber Clutch

Overrunning Clutches and Holdbacks

Heidelberg, Germany
+49 (0) 6221-30470

For information concerning our sales offices in Asia Pacific check our website www.altramotion.com.cn



www.tbwoods.com

2000 Clovis Barker Road
 San Marcos, TX 78666
 512-353-4000